

# WIPE TEST PLAN ISOTOPE LAB

S/N for van

625.5.02

Propose:

This plan is to be used to define the zone to be tested during a wipe test. Each zone used is to be wipe tested. This will ensure that each PI has an opportunity to detect spills & define back-round noise, allowing the clean up procedure to be used where needed.

**ANY AREA EXCEEDING 100 DMP MUST BE CLEANED and RE-TESTED**

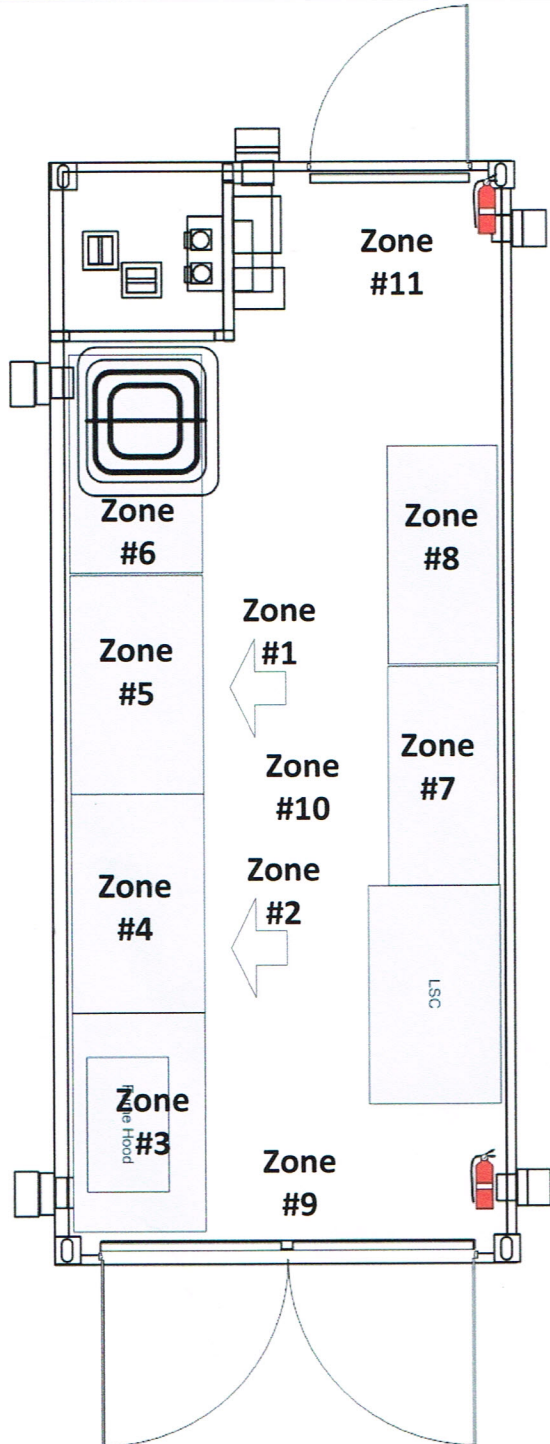

ZONE #1	Inside freezer & handle of door	Vial / DPMA / DPMB / DPMC / <u>1/1093</u> / ___ / ___ / ___
ZONE #2	Inside refrigerator & handle of door	Vial / DPMA / DPMB / DPMC / <u>2/202</u> / ___ / ___ / ___
ZONE #3	Wooden counter top & fume hood	Vial / DPMA / DPMB / DPMC / <u>3/1072</u> / ___ / ___ / ___
ZONE #4	Wooden counter top	Vial / DPMA / DPMB / DPMC / <u>4/1272</u> / ___ / ___ / ___
ZONE #5	Wooden counter top	Vial / DPMA / DPMB / DPMC / <u>5/1018</u> / ___ / ___ / ___
ZONE #6	Wooden counter top	Vial / DPMA / DPMB / DPMC / <u>6/779</u> / ___ / ___ / ___
ZONE #7	Wooden counter top	Vial / DPMA / DPMB / DPMC / <u>7/1072</u> / ___ / ___ / ___
ZONE #8	Wooden counter top	Vial / DPMA / DPMB / DPMC / <u>8/1170</u> / ___ / ___ / ___
ZONE #9	Floor & door handle entrance	Vial / DPMA / DPMB / DPMC / <u>9/1230</u> / ___ / ___ / ___
ZONE #10	Middle floor	Vial / DPMA / DPMB / DPMC / <u>10/1203</u> / ___ / ___ / ___
ZONE #11	Floor & door handle entrance	Vial / DPMA / DPMB / DPMC / <u>11/939</u> / ___ / ___ / ___
ZONE #12	Stainless steel tray	Vial / DPMA / DPMB / DPMC / <u>12/702</u> / ___ / ___ / ___
ZONE #13	Stainless steel tray	Vial / DPMA / DPMB / DPMC / ___ / ___ / ___
ZONE #14	Science option	Vial / DPMA / DPMB / DPMC / ___ / ___ / ___
ZONE #15	Science option	Vial / DPMA / DPMB / DPMC / ___ / ___ / ___
CONTROL		Vial / DPMA / DPMB / DPMC / ___ / ___ / ___

Pre Cruise

Daily Cruise Test

Post cruise

Cruise 04-03-2012  
Kessler

Date 8/13/12

P.I. Kessler

R.S.O. Woody

# WIPE TEST PLAN ISOTOPE LAB

S/N for van

625.5.02

Propose:

This plan is to be used to define the zone to be tested during a wipe test. Each zone used is to be wipe tested. This will ensure that each PI has an opportunity to detect spills & define back-round noise, allowing the clean up procedure to be used where needed.

**ANY AREA EXCEEDING 100 DMP MUST BE CLEANED and RE-TESTED**

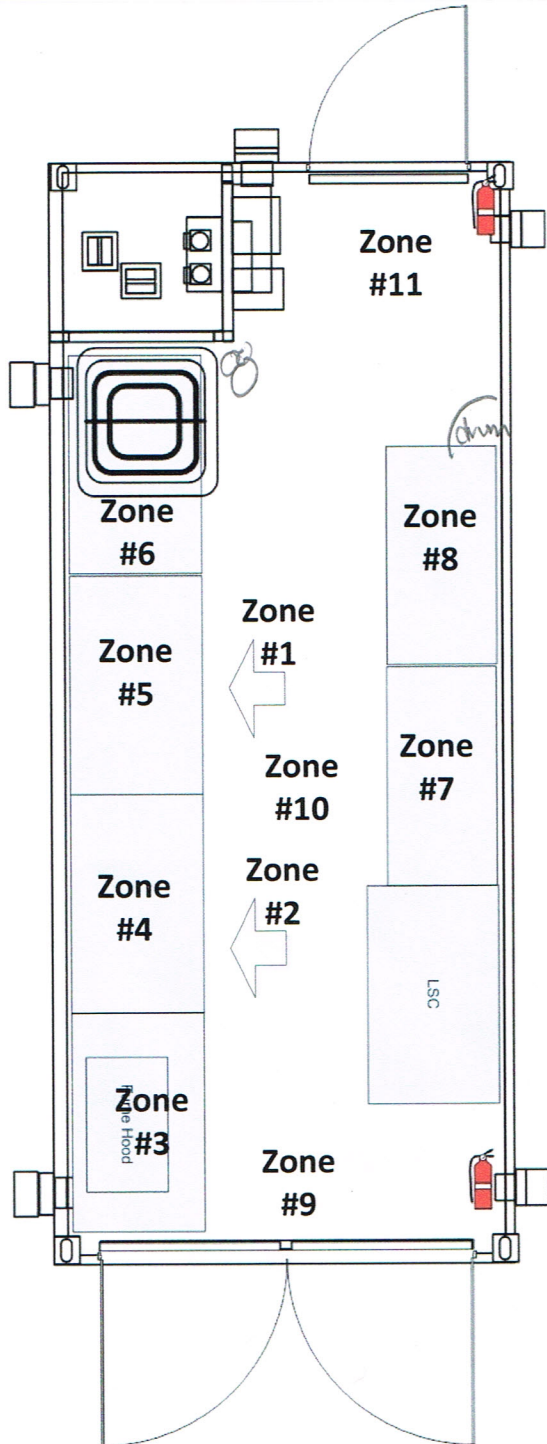

ZONE #1	Inside freezer & handle of door	Vial / DPMA / DPMB / DPMC / <u>1 / 43 /</u>
ZONE #2	Inside refrigerator & handle of door	Vial / DPMA / DPMB / DPMC / <u>2 / 42 /</u>
ZONE #3	Wooden counter top & fume hood	Vial / DPMA / DPMB / DPMC / <u>3 / 54 /</u>
ZONE #4	Wooden counter top	Vial / DPMA / DPMB / DPMC / <u>4 / 52 /</u>
ZONE #5	Wooden counter top	Vial / DPMA / DPMB / DPMC / <u>5 / 30 /</u>
ZONE #6	Wooden counter top	Vial / DPMA / DPMB / DPMC / <u>6 / 33 /</u>
ZONE #7	Wooden counter top	Vial / DPMA / DPMB / DPMC / <u>7 / 43 /</u>
ZONE #8	Wooden counter top	Vial / DPMA / DPMB / DPMC / <u>8 / 33 /</u>
ZONE #9	Floor & door handle entrance	Vial / DPMA / DPMB / DPMC / <u>9 / 43 /</u>
ZONE #10	Middle floor	Vial / DPMA / DPMB / DPMC / <u>10 / 34 /</u>
ZONE #11	Floor & door handle entrance	Vial / DPMA / DPMB / DPMC / <u>11 / 48 /</u>
ZONE #12	Stainless steel tray	Vial / DPMA / DPMB / DPMC / <u>12 / 32 /</u>
ZONE #13	Stainless steel tray	Vial / DPMA / DPMB / DPMC / <u> / /</u>
ZONE #14	Science option	Vial / DPMA / DPMB / DPMC / <u> / /</u>
ZONE #15	Science option	Vial / DPMA / DPMB / DPMC / <u> / /</u>
	CONTROL	Vial / DPMA / DPMB / DPMC / <u> / /</u>

Pre Cruise      Cruise \_\_\_\_\_

Daily Cruise Test      Date 8/7/12

Post cruise      P.I. Kessler

R.S.O. \_\_\_\_\_



# Wipe Test Plan UNOLS POOL Isotope Van

Propose:  
 This plan is to be used to define the zones to be tested. This will ensure that each PI has an opportunity to detect spills & define back round noise. This will allow clean up procedures to be used where needed.  
**ANY AREA EXCEEDING 100 DPM MUST BE CLEANED AND RETESTED.**

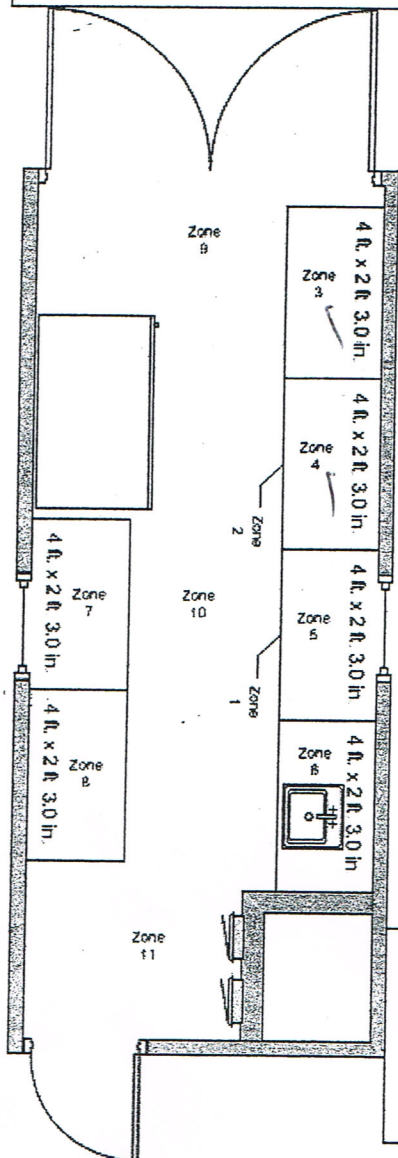

Zone #	Description	Vial / DPMA / DPMB / DPMC / SIS
#1	Inside freezer under counter.	1, 29, 69, 172
#2	Inside refrigerator under counter.	2, 5, 21, 148
#3	Wooden counter top & Fume Hood.	3, 2, 1, 159
#4	Wooden counter top.	4, 7, 1, 169
#5	Wooden counter top.	5, 5, 0, 123
#6	Wooden counter top.	6, 3, 5, 162
#7	Wooden counter top.	7, 0, 0, 10
#8	Wooden counter top.	8, 10, 1, 138
#9	Floor double door entrance.	9, 4, 1, 124
#10	Middle van floor area.	10, 4, 2, 10
#11	Floor single door entrance.	11, 2, 1, 12
#12	Stainless Steel Tray	12, 7, 1, 164
#13	Stainless Steel Tray	13, 0, 1, 160
#14	Science Option	/ / / / /
#15	Science Option	/ / / / /
Control		/ / / / /

Pre Cruise  
 During Cruise  
 Post Cruise

Ship RV Ron Brown  
 Cruise SO Gas EX  
 Date April 9, 2008  
 P.I. Sabine/Ho  
 R.S.O. \_\_\_\_\_

# Wipe Test Plan UNOLS POOL Isotope Van

**Propose:**

This plan is to be used to define the zones to be tested. This will ensure that each PI has an opportunity to detect spills & define back round noise. This will allow clean up procedures to be used where needed.

**ANY AREA EXCEEDING 100 DPM MUST BE CLEANED AND RETESTED.**

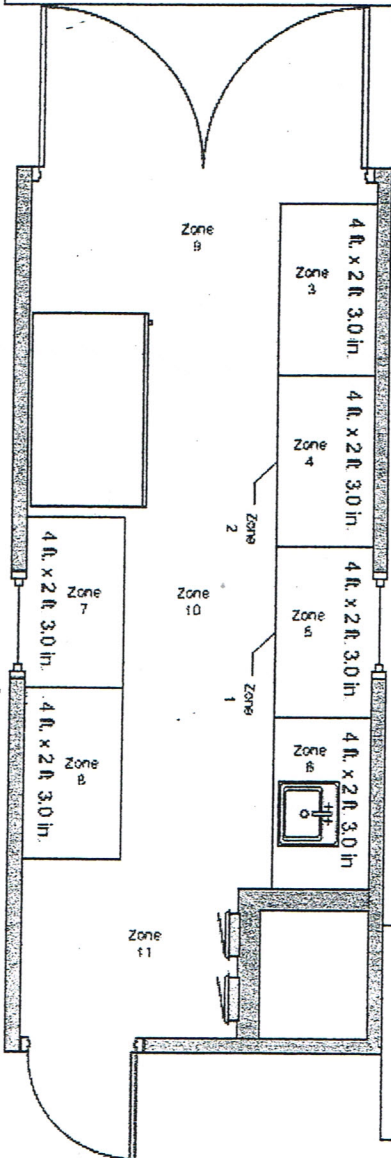

Zone #	Description	Vial / DPMA / DPMB / DPMC / SIS
Zone #1	Inside freezer under counter.	1, 0, 9, 183
Zone #2	Inside refrigerator under counter.	2, 11, 28, 75
Zone #3	Wooden counter top & Fume Hood	3, 0, 4, 975
Zone #4	Wooden counter top.	4, 0, 11, 75
Zone #5	Wooden counter top.	5, 6, 11, 163
Zone #6	Wooden counter top.	6, 0, 6, 170
Zone #7	Wooden counter top.	7, 11, 173, 82
Zone #8	Wooden counter top.	8, 0, 4, 51
Zone #9	Floor double door entrance.	9, 3, 0, 0
Zone #10	Middle van floor area.	10, 0, 6, 0
Zone #11	Floor single door entrance.	11, 0, 5, 10
Zone #12	Stainless Steel Tray	12, 0, 0, 0
Zone #13	Stainless Steel Tray	13, 0, 6, 1627
Zone #14	Science Option	____ / ____ / ____ / ____ / ____
Zone #15	Science Option	____ / ____ / ____ / ____ / ____
Control		____ / ____ / ____ / ____ / ____

TWO

Pre Cruise  
 During Cruise  
 Post Cruise

Ship \_\_\_\_\_  
 Cruise \_\_\_\_\_  
 Date 11/15/07  
 P.I. \_\_\_\_\_  
 R.S.O. Tim Deering

# Wipe Test Plan UNOLS POOL Isotope Van

**Propose:**

This plan is to be used to define the zones to be tested. This will ensure that each PI has an opportunity to detect spills & define back round noise. This will allow clean up procedures to be used where needed.

**ANY AREA EXCEEDING 100 DPM MUST BE CLEANED AND RETESTED.**

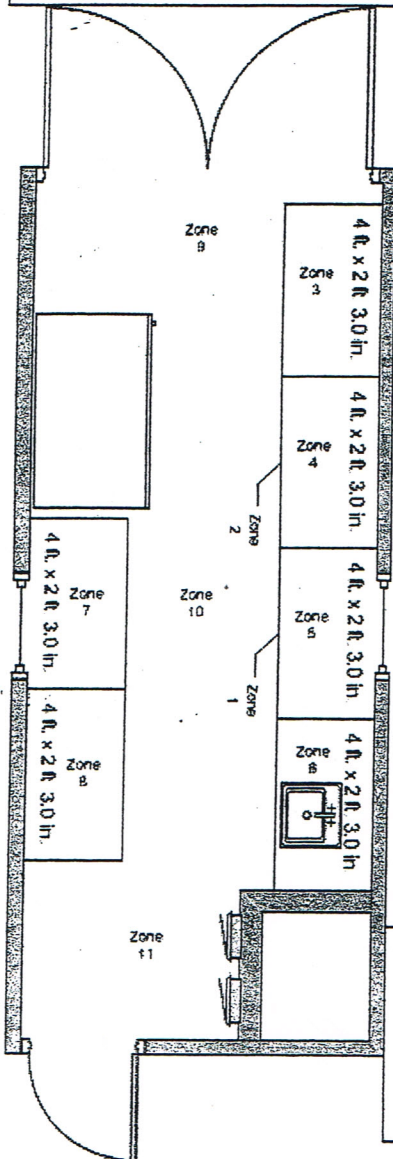

Zone #	Description	Vial / DPMA / DPMB / DPMC / SIS
#1	Inside freezer under counter.	1, 0, 11, 181
#2	Inside refrigerator under counter.	2, 8, 30, 165
#3	Wooden counter top & Fume Hood.	3, 3, 10, 10
#4	Wooden counter top.	4, 0, 8, 10
#5	Wooden counter top.	5, 1, 15, 161
#6	Wooden counter top.	6, 0, 3, 10
#7	Wooden counter top.	7, 13, 170, 182
#8	Wooden counter top.	8, 0, 10, 101
#9	Floor double door entrance.	9, 0, 4, 10
#10	Middle van floor area.	10, 0, 2, 10
#11	Floor single door entrance.	11, 6, 10, 14
#12	Stainless Steel Tray	12, 0, 8, 135
#13	Stainless Steel Tray	13, 6, 3, 18
#14	Science Option	_____
#15	Science Option	_____
Control		_____

Pre Cruise  
 During Cruise  
 Post Cruise  
*re check*

Ship \_\_\_\_\_  
 Cruise \_\_\_\_\_  
 Date 11/15/07  
 P.I. \_\_\_\_\_  
 R.S.O. Tim Deering